

TO
LET

£950 PCM

Stirling Court, Frosthole Crescent,
Fareham, PO15 6DH



HIGHLIGHTS

- ❖ ALLOCATED PARKING
- ❖ TWO BEDROOMS
- ❖ LIVING/DINING ROOM
- ❖ SEPERATE KITCHEN
- ❖ NETURALLY DECORATED
- ❖ UNFURNISHED
- ❖ COMMUNAL GARDENS
- ❖ GROUND FLOOR
- ❖ CLOSE TO LOCAL SHOPS
- ❖ AVAILABLE NOW

We are delighted to bring to the rental market this two bedroom apartment.

Stirling Court is a fine detached brick built building located in central Fareham just of Highlands Road. This particular apartment consists of one double bedroom, one single bedrooms and an open plan Living/Dining room which leads on to a kitchen and a fitted bathroom with shower over bath. This apartment has the added bonus of allocated parking and gas central heating making it a fantastic opportunity to rent something unique.

This flat will not be on the rental market for much longer so give our Fareham office a call on 01329 756 500 to avoid disappointment.

AVAILABLE NOW

 2  1  1



GROUND FLOOR
537 sq.ft. (49.9 sq.m.) approx.

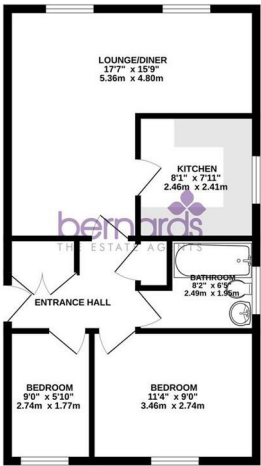

TOTAL FLOOR AREA: 537 sq.ft. (49.9 sq.m.) approx.
While every effort has been made to ensure the accuracy of the floorplan contained here, measurements of areas, volumes, levels, etc. are given here as approximate and no responsibility is taken for any error or omission in this document. This plan is for illustrative purposes only and should be used as such for the sole purpose of providing a general impression of the property. The images herein are for illustrative purposes only.
Made with Design Cloud



Energy Efficiency Rating		
	Current	Potential
Very energy efficient - lower running costs		
(92 plus) A		
(81-91) B		
(69-80) C		
(55-68) D		
(39-54) E		
(21-38) F		
(1-20) G		
Not energy efficient - higher running costs		
	71	74
England & Wales		
EU Directive 2002/91/EC		

